

# WRIGHT ON! UNITY

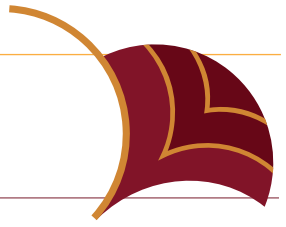

Frank Lloyd Wright loved to use shapes in imaginative ways and often repeated the same shape throughout a project. Rooms and then the details inside- furniture, lighting, and decoration- would follow the same form so that all the parts fit together and created a feeling of unity. Monona Terrace is designed in circular forms, with unusual curved walls and corners that create unique spaces.

Architects create floor plans to show their clients a “birds-eye view” of the location of rooms. Wright laid out floor plans on square grids, rectangular grids, even triangular grids. Now it’s your turn: use the lines as your guide to create a living room, kitchen, bedrooms, and bathroom. Imagine walking through this house. How would the unusual corners and spaces affect your experience of the rooms? How would it affect how you lived in your home?

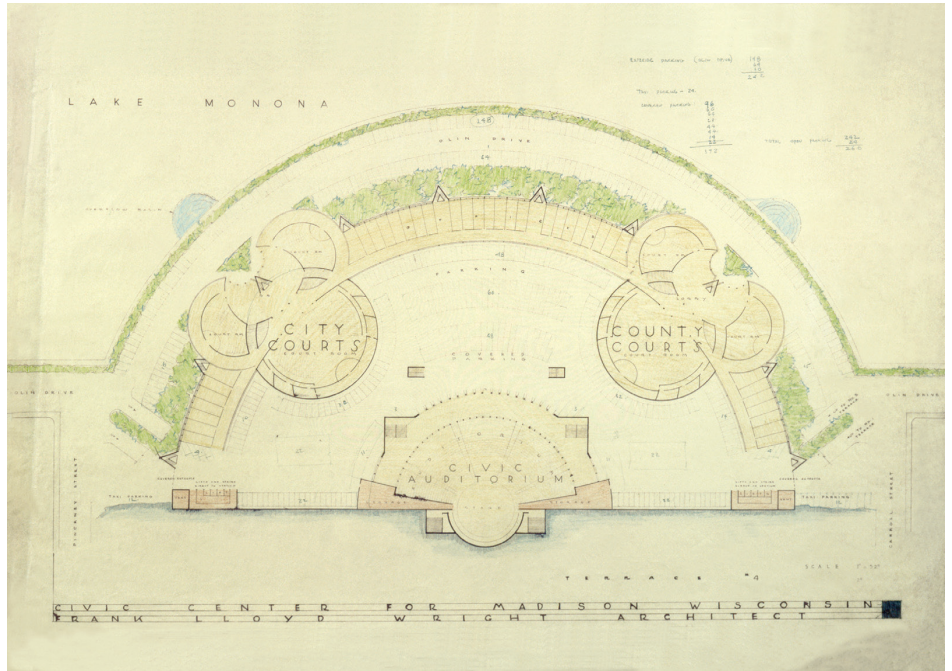

© The Frank Lloyd Wright Foundation, Taliesin West, Scottsdale, AZ

